

PANNELLI SOTTOPORTA BUGNATI **PSB** RUSTICATED LOWER DOOR PANELS

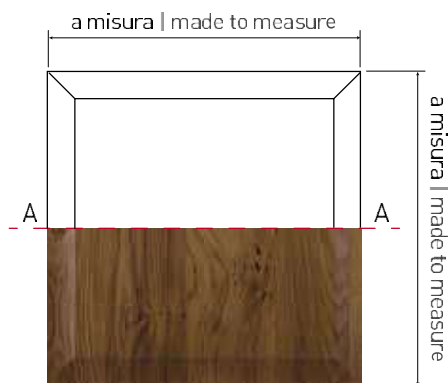

PANNELLI SOTTOPORTA DOGATI **PDC** SLATTED LOWER DOOR PANELS

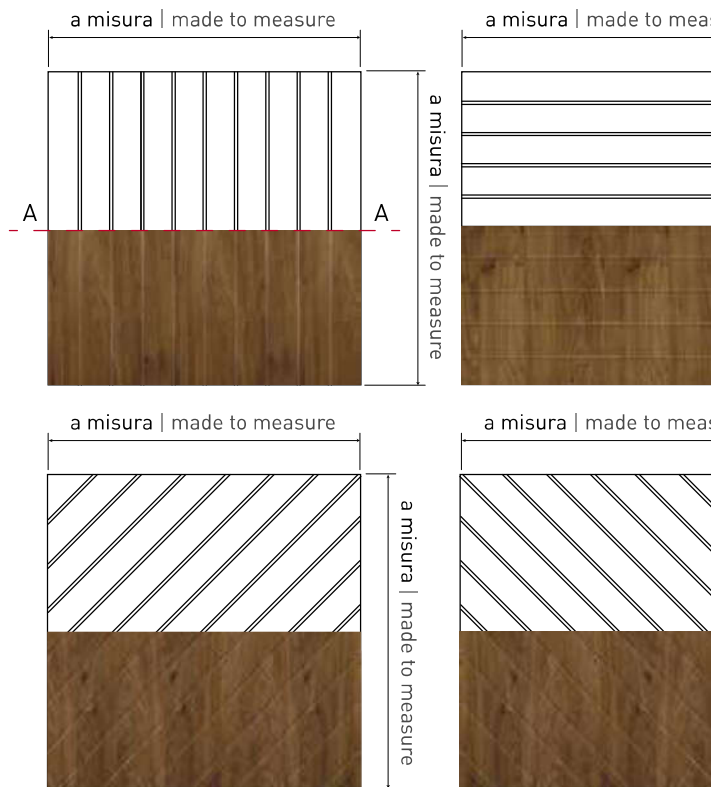

STRUTTURA BASIC PSB | BASIC PSB PANEL

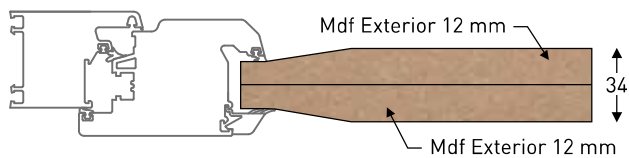

STRUTTURA BASIC PDC | BASIC PDC PANEL

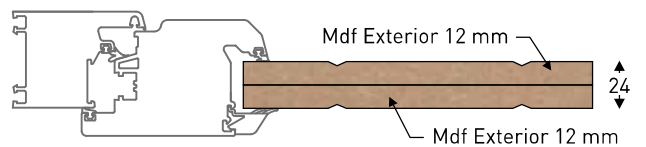

STRUTTURA BASIC CLIMA PSB | BASIC CLIMA PSB PANEL

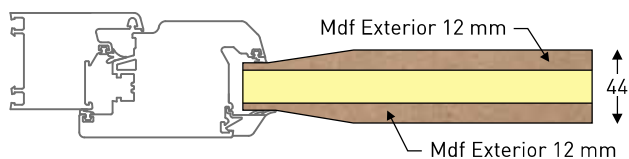

STRUTTURA BASIC CLIMA PDC | BASIC CLIMA PDC PANEL

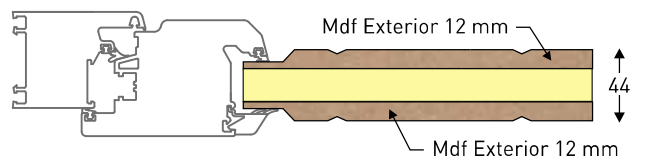

STRUTTURA CLASSIC PSB | CLASSIC PSB PANEL

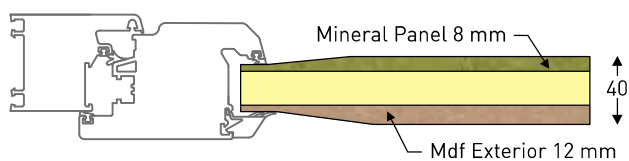

STRUTTURA CLASSIC PDC | CLASSIC PDC PANEL

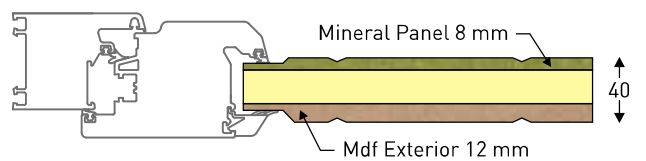

STRUTTURA CLASSIC PLUS PSB | CLASSIC PLUS PSB PANEL

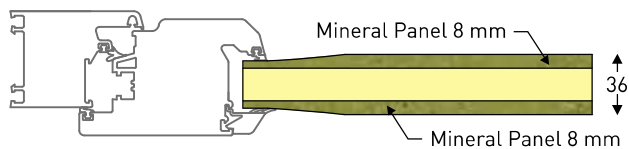

STRUTTURA CLASSIC PLUS PDC | CLASSIC PLUS PDC PANEL

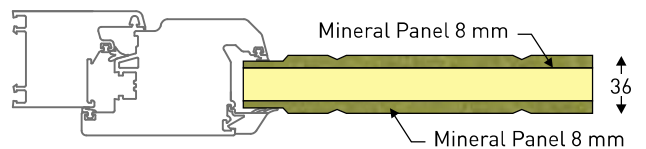

LI SOTTOPORTA PANTOGRAFATI **PSP** CONTOURED LOWER DOOR PANELS

PANNELLI SOTTOPORTA LISCI **PSL** SMOOTH LOWER DOOR PANELS

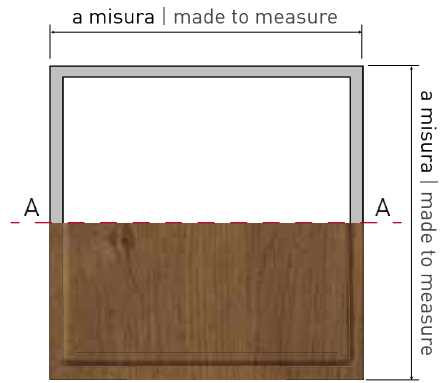
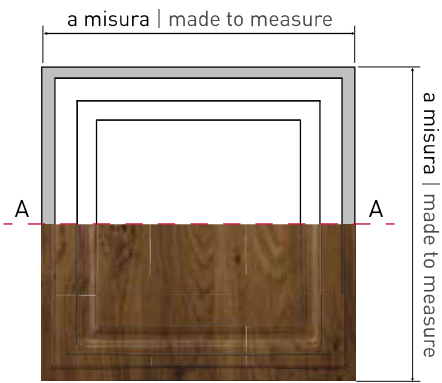

STRUTTURA BASIC PSP | BASIC PSP PANEL

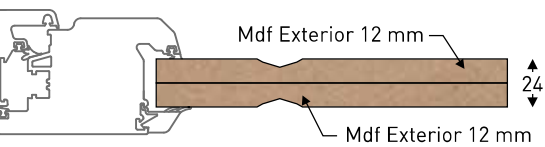

STRUTTURA BASIC PSL | BASIC PSL PANEL

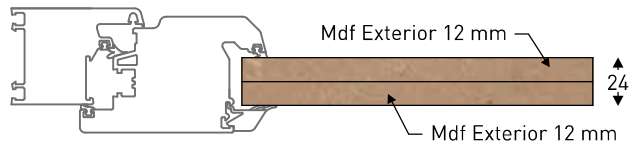

STRUTTURA BASIC CLIMA PSP | BASIC CLIMA PSP PANEL

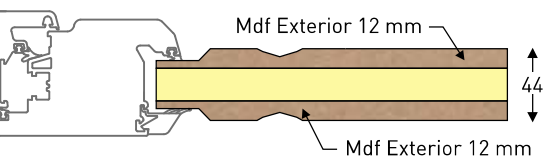

STRUTTURA BASIC CLIMA PSL | BASIC CLIMA PSL PANEL

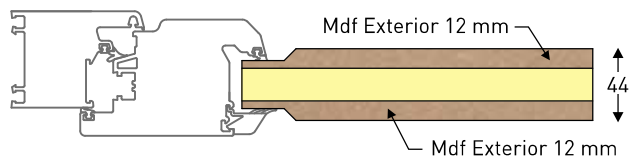

STRUTTURA CLASSIC PSP | CLASSIC PSP PANEL

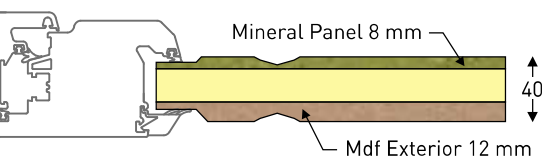

STRUTTURA CLASSIC PSL | CLASSIC PSL PANEL

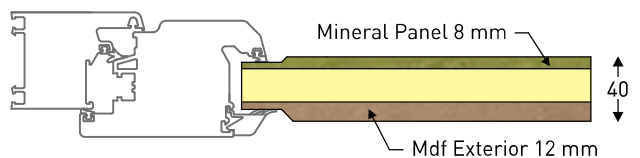

STRUTTURA CLASSIC PLUS PSP | CLASSIC PLUS PSP PANEL

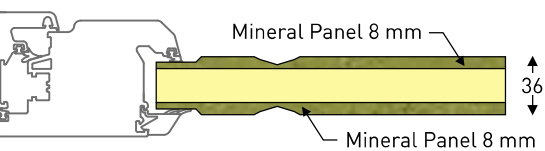

STRUTTURA CLASSIC PLUS PSL | CLASSIC PLUS PSL PANEL

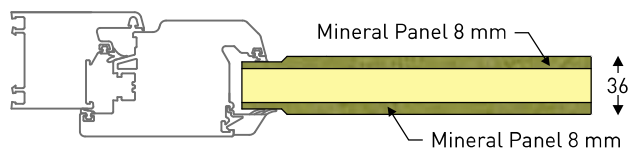

La trasmittanza termica, detta anche Coefficiente U ($W/m^2.K$), è un termine energetico che indica il flusso di calore medio che passa, per metro quadrato di superficie, attraverso una struttura che delimita due ambienti a temperatura diversa.

In questo senso definisce la capacità isolante di un elemento. Questo valore è importante in quanto l'obiettivo del risparmio energetico è minimizzare la dispersione di calore; quindi, è necessario che tutti gli elementi che costituiscono l'involucro edilizio abbiano un basso valore di trasmittanza termica, così da ridurre la quantità di calore perso.

Come ogni elemento dell'edificio, anche il pannello MDF e MINERALPANEL rivestito di pellicola PVC, destinato a portoncini e blindati, contribuisce alla prestazione globale del sistema in termini di trasmittanza.

Tutti i pannelli prodotti e commercializzati da Teknodue Group rappresentano la soluzione ideale per il rivestimento di portoncini e blindati soprattutto perché assicurano un ottimo investimento per il futuro e un elevato risparmio energetico.

Secondo la relazione di calcolo dell'Istituto Giordano e CNR-IVALSA, il valore di trasmittanza termica della parte centrale del pannello va da un minimo di $0,89W/m^2.K$ a un massimo di $0,48W/m^2.K$.

Thermal transmittance, generally expressed in terms of a U-value ($W/m^2.K$), is a measure of the average heat per square metre of surface area that can pass through a structure between two environments at different temperatures.

In other words, the U-value tells us the insulation capacity of an element. This value is therefore a vital indicator of whether heat conservation and energy saving targets are being met. To reduce heat loss, all components that constitute the external shell of a building must possess a low U-value.

Hence, like every other construction component, doors and windows panels must play their part to ensure thermal transmittance remains as low as possible.

With their MDF and MINERALPANEL structure and PVC-film covering, Teknodue Group panels all present a low U-value and therefore contribute to the overall performance of a building in terms of heat conservation and energy saving. This makes them ideal for use in combination and security doors and a solid investment for the future.

According to the calculation report by the Jordan Institute and CNR-IVALSA, the thermal transmittance value of the central part of the panel ranges from a minimum of $0.89W/m^2.K$ to a maximum of $0.48W/m^2.K$.

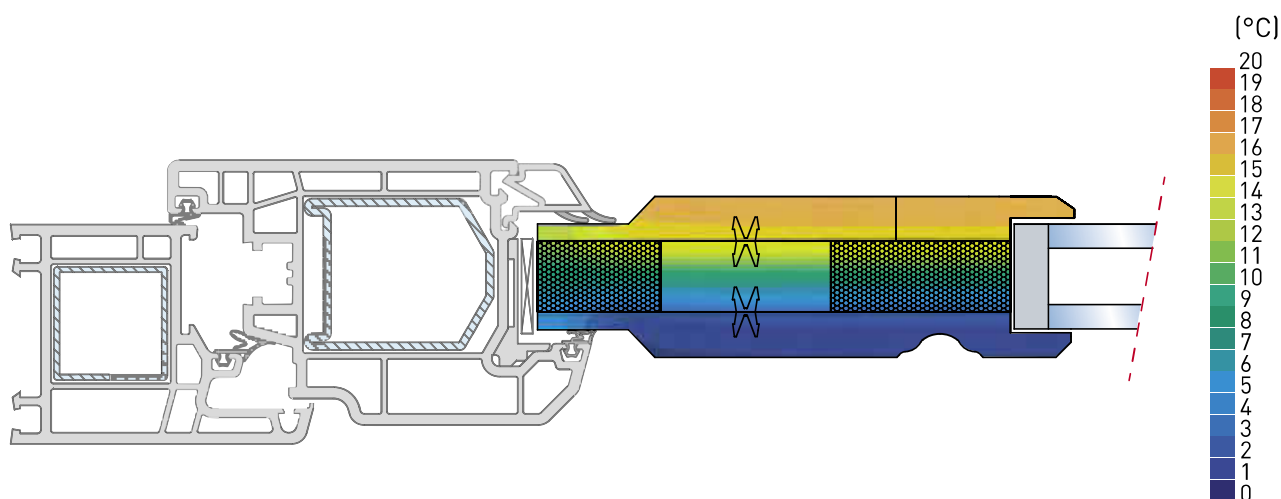

re piane sono pannelli in MDF e in MINERALPANEL rivestiti con
le in PVC, disponibili in diversi colori e con spessore di 8-10 mm
e 8 mm (MINERALPANEL).

due Group propone una vasta gamma di personalizzazioni, sia su
lato che su entrambi.

These flat sheets are made of MDF and MINERALPANEL coated with
PVC film. They are 8-10 mm (MDF) or 8 mm (MINERALPANEL), thick
and come in a range of colours.

Teknodue Group offers a wide range of custom coatings on one or both
sides.



Teknodue Group offre un'ampia gamma di finiture e colorazioni in grado di soddisfare ogni esigenza di abbinamento. L'aspetto è un elemento molto importante quando si tratta di armonia e comfort, per cui scegliere la tonalità di colore giusta significa rendere la casa ancora più bella, calda e accogliente. Le finiture vengono aggiornate periodicamente con le novità proposte dalle case di produzione. L'ufficio commerciale di Teknodue Group è a disposizione per soddisfare, senza impegno, ogni esigenza.

Teknodue Group offers a wide range of finishes and colours that can satisfy any colour-matching need. Appearance is very important when it comes to harmony and comfort, and choosing the right shade makes home even more beautiful, cosy and welcoming. The finishes are updated periodically with the innovations proposed by the manufacturing companies. Teknodue Group's sales office is at disposal and we aim to meet every need.

